

02nd November 2020

Planning Department
Longford County Council
Great Water Street
Longford

SUBMISSION TO: DRAFT COUNTY DEVELOPMENT PLAN 2021 – 2027

Dear Sirs:

As part of the Public Consultation process in relation to Longford County Council's **Draft County Development Plan 2021 – 2027** I wish to make representation for the following Land Zoning Change as detailed below and in the attached associated area maps.

Townland: Knockawalky
Townland Code: N11616
Parcel No: N11616001
Gross Area: 2.16 Ha
Folio Number: LD12402
Current Zoning: Agricultural use

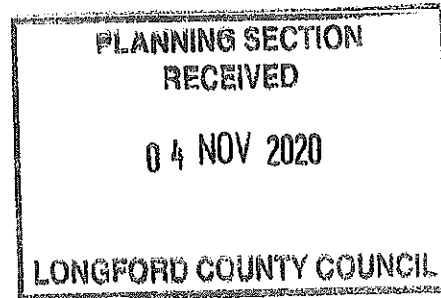

Requested Change: RESIDENTIAL use

The parcel of land in question is of very limited agricultural use however it is ideally suited for residential development as it is:

- In close proximity to other residential developments and standalone private dwellings
- Fronting directly onto a main secondary public roadway
- Easily assessable to nearby local urban areas (e.g. Longford Town, Newtownforbes)
- Adjacent (within walking distance) of local amenities i.e. Melview Primary School
- Within walking distance of local public transport routes (Bus Services)
- Within easy reach for all main utility connections – Electricity, Mains Water, Broadband

Yours faithfully,

Rose McCann

Rose McCann

(Enclosed: OSI Area Map)

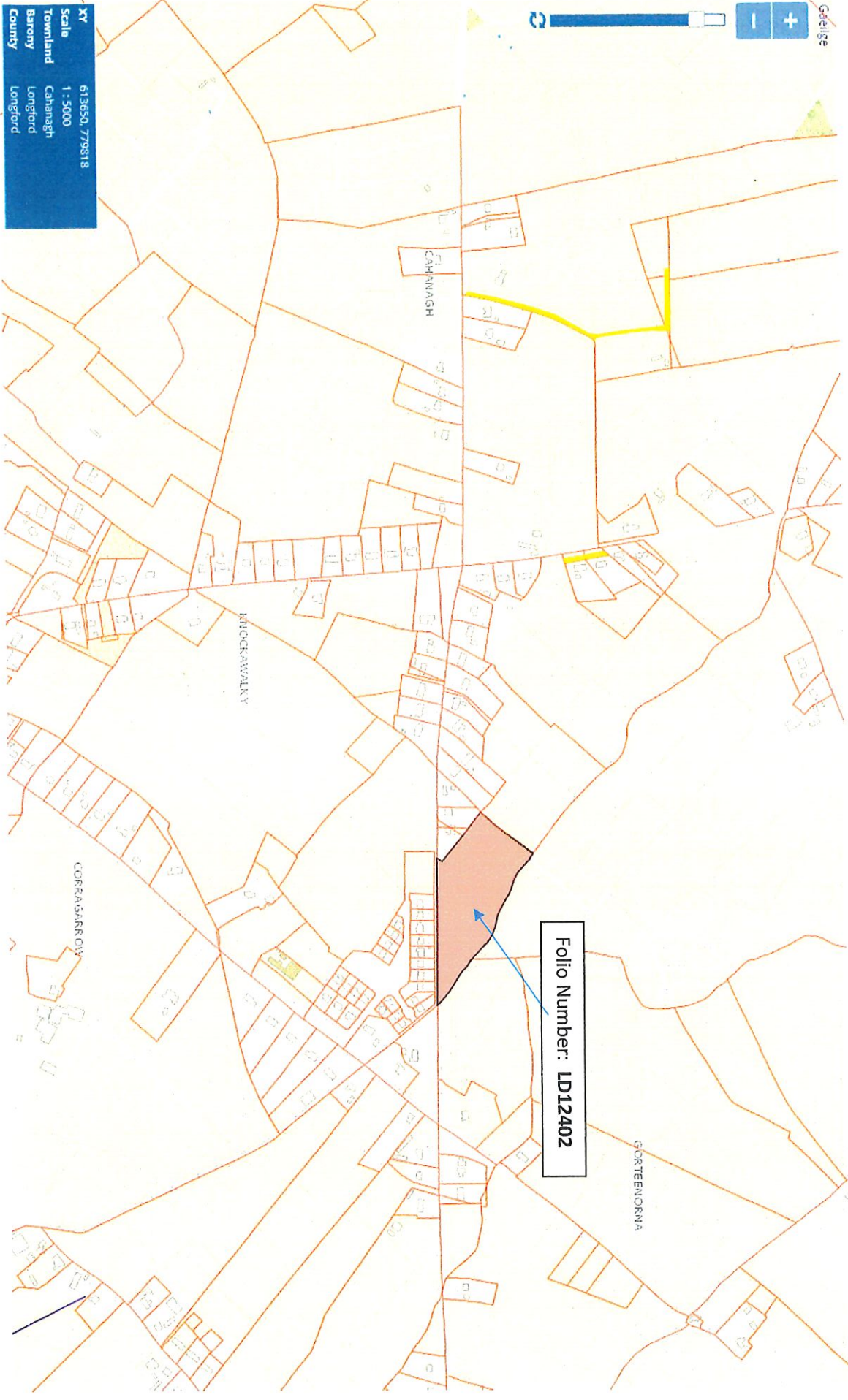

Folio Number: LD12402

XY	613650, 779818
Scale	1:5000
Townland	Cahanagh
Barony	Longford
County	Longford

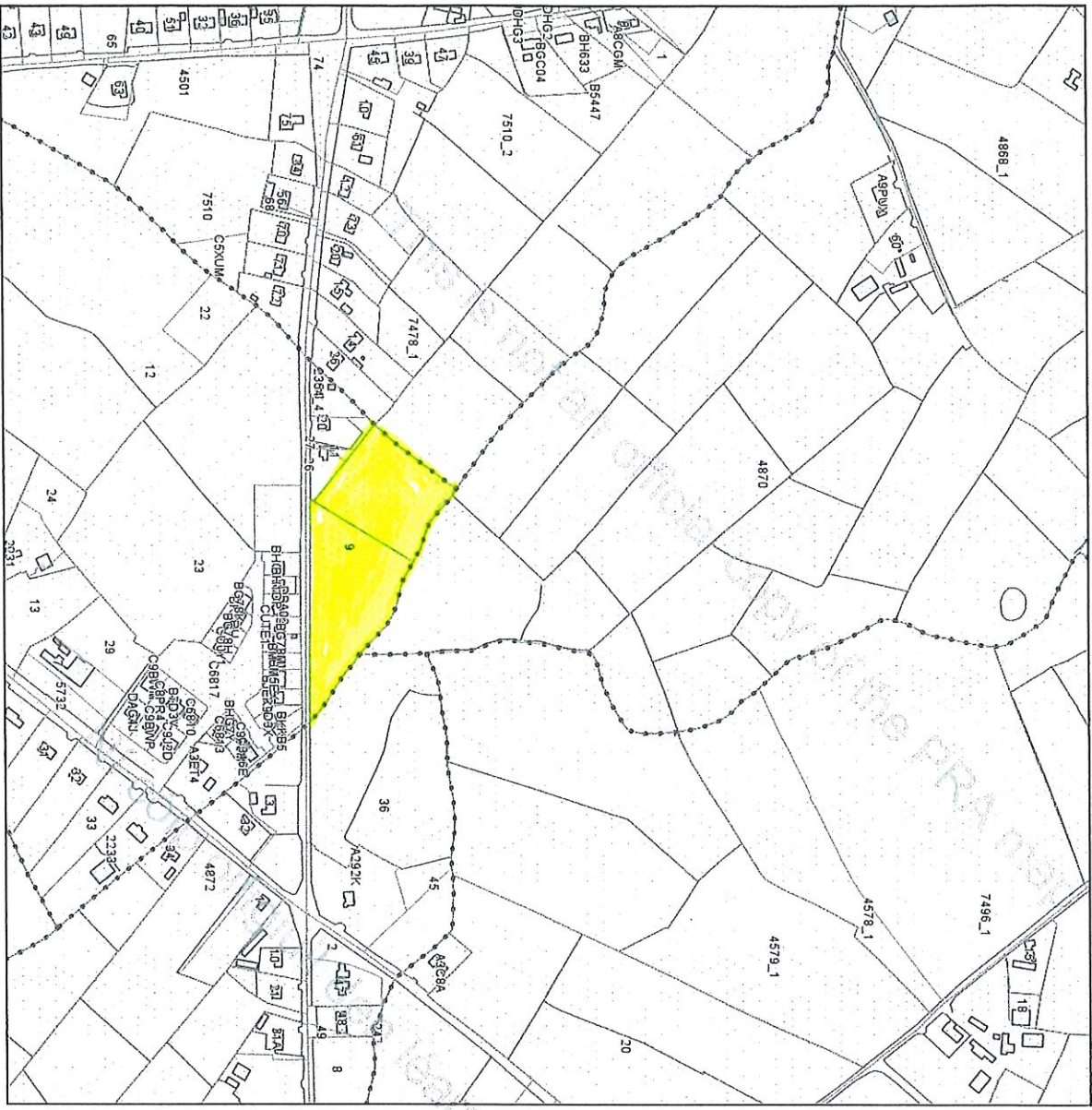

The Property Registration Authority An tÚdarás Clárúcháin Maoinne



Official Property Registration Map

This map should be read in conjunction with the folio.

Registry maps are based on OSI topographic mapping. Where registry maps are printed at a scale that is larger than the OSI published scale accuracy is limited to that of the original OSI Map Scale.

For details of the terms of use, and limitations as to scale, accuracy and other conditions relating to Land Registry Maps, see www.pra.ie.

This map incorporates Ordnance Survey Ireland (OSI) mapping data under a licence from OSI. Copyright © OSI and Government of Ireland.

- (centre-line of parcel(s) edged)
 - Freehold
 - Leasehold
 - Subleasehold
 - 'S' Register
- (see Section 8(3)(ii) of Registration of Title Act 1964 and Rule 224 & 225 Land Registration Rules 1972 - 2010).

- Burdens (may not all be represented on map)
- Right of Way / Wayleave
 - Turbine
 - Pipeline
 - Well
 - Pump
 - Septic Tank
 - Soak Pit
- A full list of burdens and their symbology can be found at www.landireg.ie

The registry operates a non-conclusive boundary system. The Registry Map identifies properties not boundaries meaning neither the description of land in a register nor its identification by reference to a registry map is conclusive as to the boundaries or extent (see Section 85 of the Registration of Title Act, 1964). As inserted by Section 62 of the Registration of Deed and Title Act 2006.





Issued by the
**DEPARTMENT OF
AGRICULTURE,
FOOD AND FORESTRY**

for area aid purposes only

Townland code: N11616

Townland name: KNOCKAWALK

Scale: 1:5000

Parcel number Gross area*

N11616001 2.08 Ha.

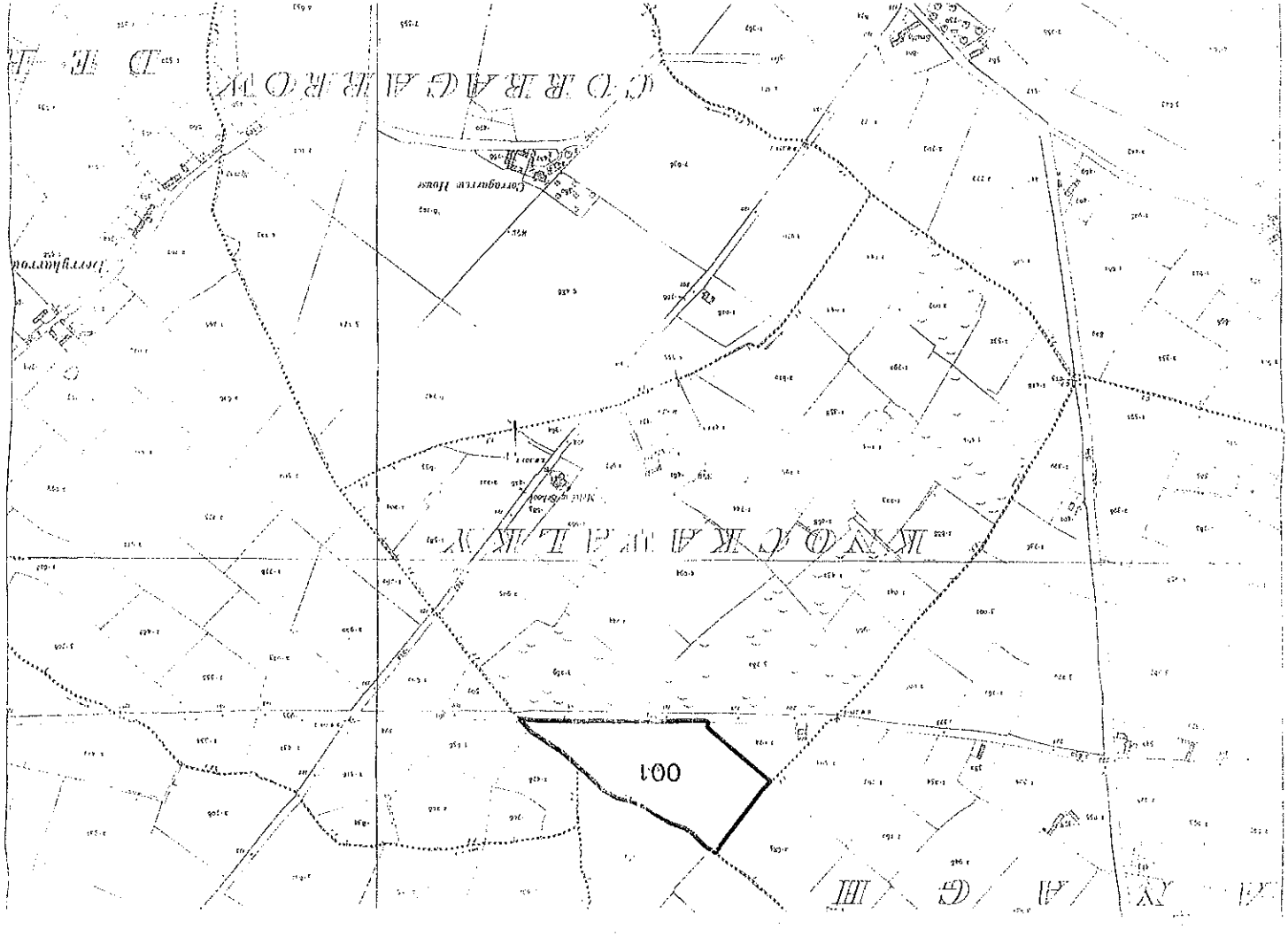
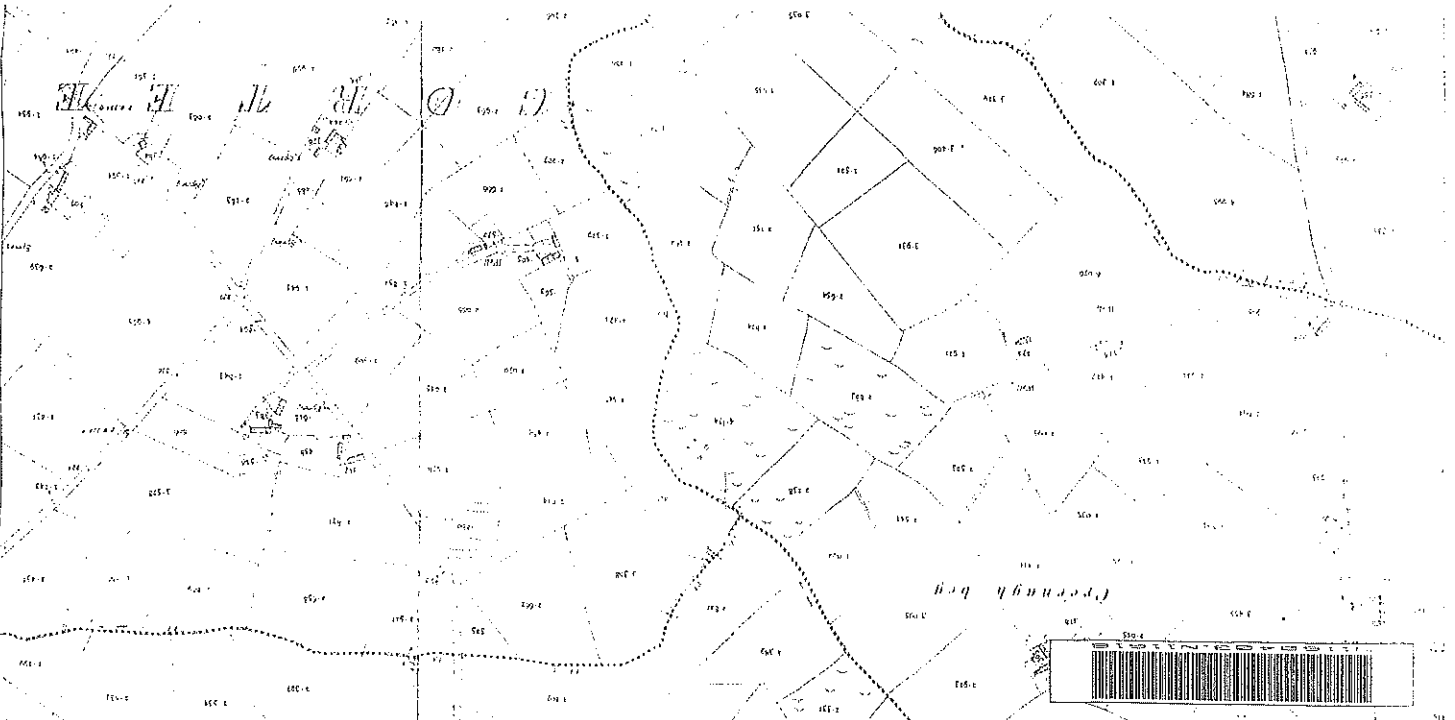

* Areas shown above are gross areas in hectares. Deductions should be made for non-agricultural areas in Area Aid Applications.
Printed under Licence No. 6155 from the *Ordnance Survey*.
© Copyright Government of Ireland 1994.
Unauthorized reproduction is not permitted.