

DCOP 11

**Sheila Healy**

---

**From:** mail@esarch.ie  
**Sent:** Monday 11 January 2021 11:04  
**To:** cdp  
**Subject:** RE: Submission of map for zoning  
**Attachments:** 1276-SK-Zoning Map.pdf

Good morning,

Please find attached zoning map in relation to a submission regarding the Draft Longford County Development Plan 2021-2027.

Applicant name: Seamus Hourican  
Applicant address: [REDACTED]  
Site address: Aghnacliff, Aghnacliff, Co. Longford

If you require additional information please don't hesitate to contact me.

Best Regards

Eamon



Eamon Sheridan M.Arch B.Arch  
Managing Director  
ESArch

[REDACTED]  
E: [mail@esarch.ie](mailto:mail@esarch.ie)  
W: [www.esarch.ie](http://www.esarch.ie)

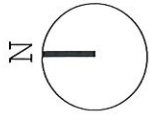

Scale 1:2500  
Date 09-01-2021  
O.S. REF: 2051, 2051-B  
Site area .355 ha  
Site outlined in red  
ITM - 625968,788105

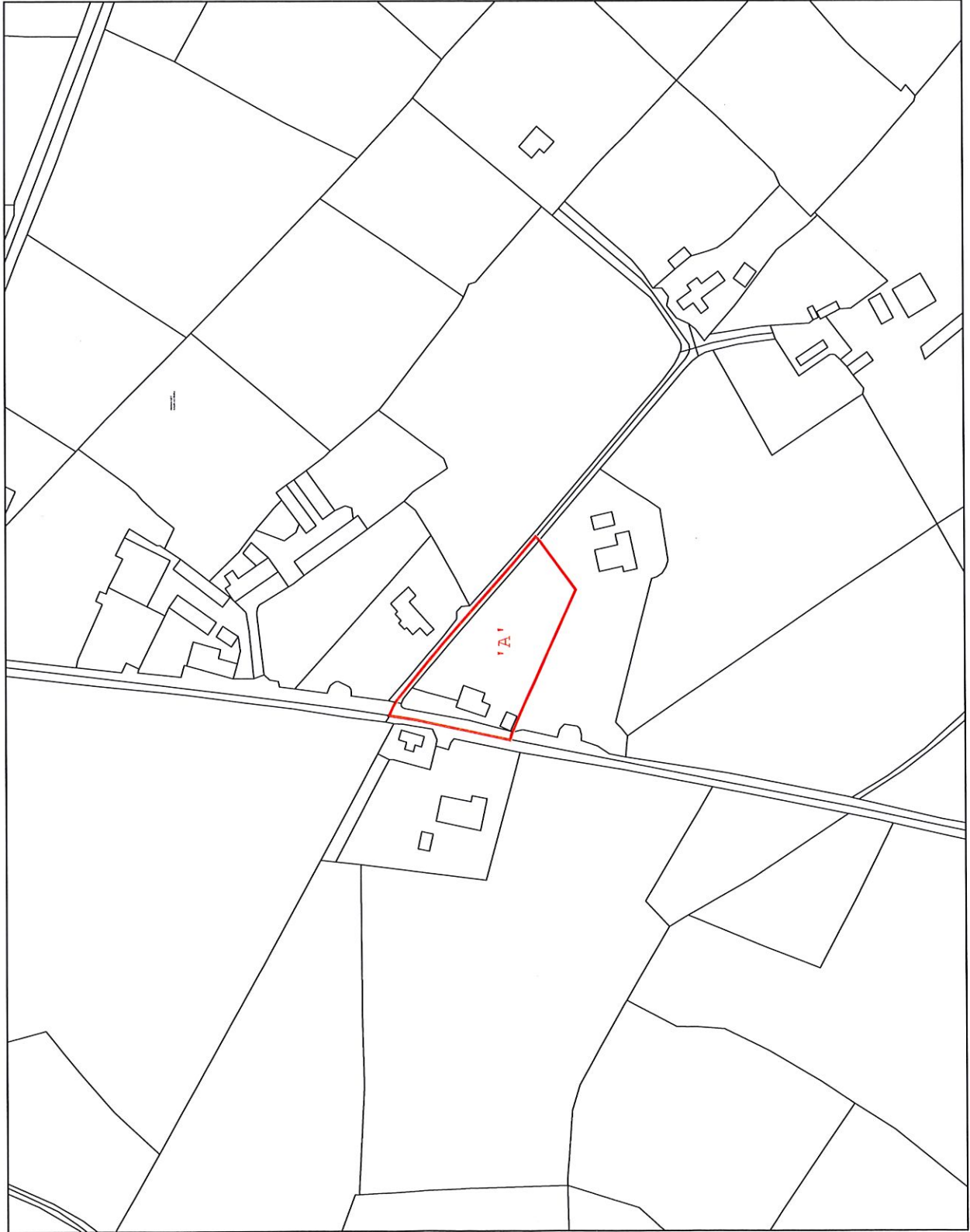

Eamon Sheridan  
ESarch  
Rosduff  
Aughnaccliffe  
Co. Longford  
Tel: 087 7994445