

COPYRIGHT AND OWNERSHIP OF THIS DRAWING IS VESTED IN DENNANY REIDY ASSOCIATES LTD. NO PART OF THIS DOCUMENT MAY BE REPRODUCED OR TRANSMITTED IN ANY FORM OR STORED IN ANY RETRIEVAL SYSTEM OF ANY NATURE WITHOUT THE WRITTEN PERMISSION OF DENNANY REIDY ASSOCIATES AS COPYRIGHT HOLDER EXCEPT AS AGREED FOR USE ON THE PROJECT FOR WHICH THE DOCUMENT WAS ORIGINALLY ISSUED.

ALL RIGHT RESERVED BY THE LAW OF COPYRIGHT AND BY INTERNATIONAL COPYRIGHT CONVENTIONS ARE RESERVED TO DENNANY REIDY ASSOCIATES LTD.©

NOTES:

1. ALL DIMENSIONS ARE IN MILLIMETRES AND LEVELS IN METRES UNLESS NOTED OTHERWISE.
2. USE FIGURED DIMENSIONS ONLY. DO NOT SCALE. ALL DIMENSIONS TO BE CHECKED ON SITE AND CONFIRMED PRIOR TO COMMENCING WORKS. ANY ERROR OR DISCREPANCIES ARE TO BE REPORTED TO THE ENGINEER / ARCHITECT.
3. DRAWINGS TO BE READ IN CONJUNCTION WITH ALL RELEVANT ENGINEERS, ARCHITECTS AND SERVICE ENGINEERS DRAWINGS AND SPECIFICATIONS.
4. ALL WORKS TO BE CARRIED OUT IN ACCORDANCE WITH CURRENT BUILDING REGULATIONS AND GOOD BUILDING PRACTICE.
5. ALL WASTEWATER DRAINAGE DETAILS AND CONSTRUCTION TO BE IN ACCORDANCE WITH IRISH WATER'S STANDARD DETAILS AND CODE OF PRACTICE FOR WASTEWATER INFRASTRUCTURE (DOCUMENT NO. IW-CDS-5020-01 & IW-CDS-5020-03 RESPECTIVELY).
6. ALL WATER INFRASTRUCTURE DETAILS AND CONSTRUCTION TO BE IN ACCORDANCE WITH IRISH WATER'S STANDARD DETAILS AND CODE OF PRACTICE FOR WATER INFRASTRUCTURE (DOCUMENT NO. IW-CDS-5020-01 & IW-CDS-5020-03 RESPECTIVELY).
7. PIPE SPECIFICATION
 - A. PIPE UNDER STRUCTURES
 - PIPES UNDER STRUCTURES TO BE CONCRETE ENCASED WITH 150mm 35N20 CONCRETE SURROUND
 - CONCRETE ENCASEMENT IS TO EXTEND 500mm PAST STRUCTURE
 - LAYER OF COMPRESSIBLE MATERIAL (SUCH AS 50mm POLYSTYRENE) IS TO BE PLACED OVER CONCRETE ENCASEMENT TO PREVENT LOADING FROM THE STRUCTURE OVER
 - COMPRESSIBLE MATERIAL IS TO EXTEND 150mm EACH SIDE OF CONCRETE ENCASEMENT
 - B. FOUL & SURFACE WATER
 - 100mm Ø uPVC, IN COMPLIANCE WITH BS 4660 AND BS EN 1401-PART 1
 - TO BE LAID AT FALLS OF 1:40 (2.5%)
 - TO BE IN COMPLIANCE WITH PART H, 2010 OF THE BUILDING REGULATIONS
 - SURFACE WATER DRAINAGE TO COMPLY WITH THE CURRENT VERSION OF THE 'GREATER DUBLIN REGIONAL CODE OF PRACTICE FOR DRAINAGE WORKS'
 - C. WATER SERVICE CONNECTION
 - MINIMUM 25mm OUTSIDE Ø, 20mm INSIDE Ø.
 - MATERIAL: HDPE PERIOD, SDR-11 RATING
 - BOUNDARY BOX WITH INTEGRAL STOP-COCK AND WATER METER AS PER IRISH WATER'S SPECIFICATION

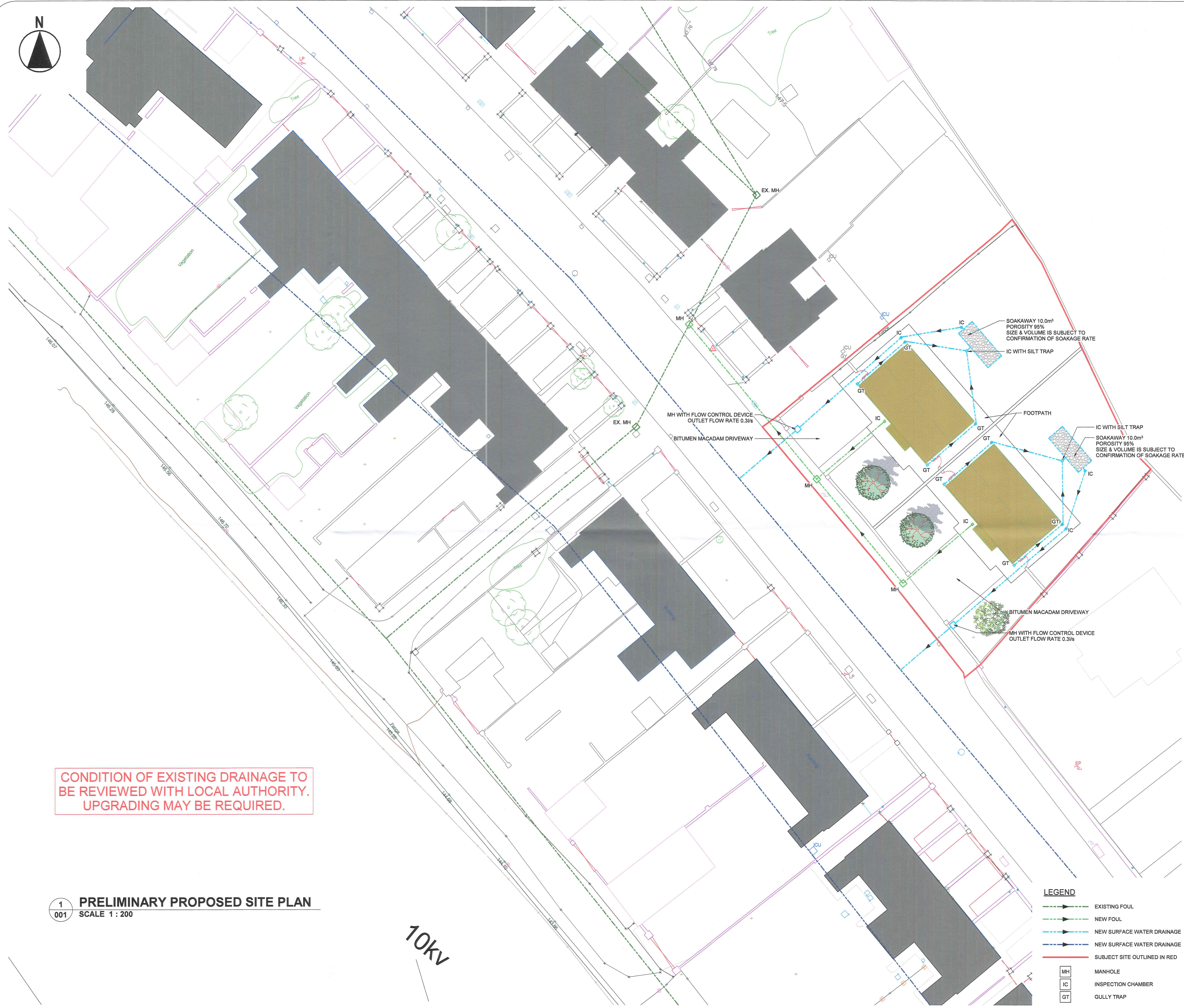

CONDITION OF EXISTING DRAINAGE TO BE REVIEWED WITH LOCAL AUTHORITY. UPGRADING MAY BE REQUIRED.

1 PRELIMINARY PROPOSED SITE PLAN
SCALE 1 : 200

10KV

LEGEND

	EXISTING FOUL
	NEW FOUL
	NEW SURFACE WATER DRAINAGE
	NEW SURFACE WATER DRAINAGE
	SUBJECT SITE OUTLINED IN RED
	MANHOLE
	INSPECTION CHAMBER
	GULLY TRAP

B	ISSUED FOR PLANNING	TB	BMG	06/06/2020
A	ISSUED FOR DISCUSSION	TB	BMG	08/05/2020
REV.	DESCRIPTION	PROD.	VERIF.	DATE

PLANNING



DUBLIN | LIMERICK | WEXFORD
T: 01-216-2956 | 061-310-701 | 053-915-2814
E: info@draconsulting.ie | W: www.draconsulting.ie

ARCHITECT: VINCENT HANNON ARCHITECTS, DEERPARK BUSINESS CENTRE, CARROWMONEASH, GALWAY			
PROJECT: REFURBISHMENT OF COLMCILLE TERRACE, GRANARD, CO. LONGFORD			
TITLE: PROPOSED SITE DRAWING			
DATE:	05/05/2020	SCALE:	As Indicated @ A1
DESIGNER:	TB	DRG. No.	
PRODUCER:	TB		
VERIFIER:	BMG	L202-001	B
APPROVER:	AD		