

*Includes Ordnance Survey Ireland data reproduced under OSI Licence No 2019/OSI_NMA_145
 Unauthorised reproduction infringes Ordnance Survey Ireland Government of Ireland copyright.
 © Ordnance Survey Ireland, year 2022

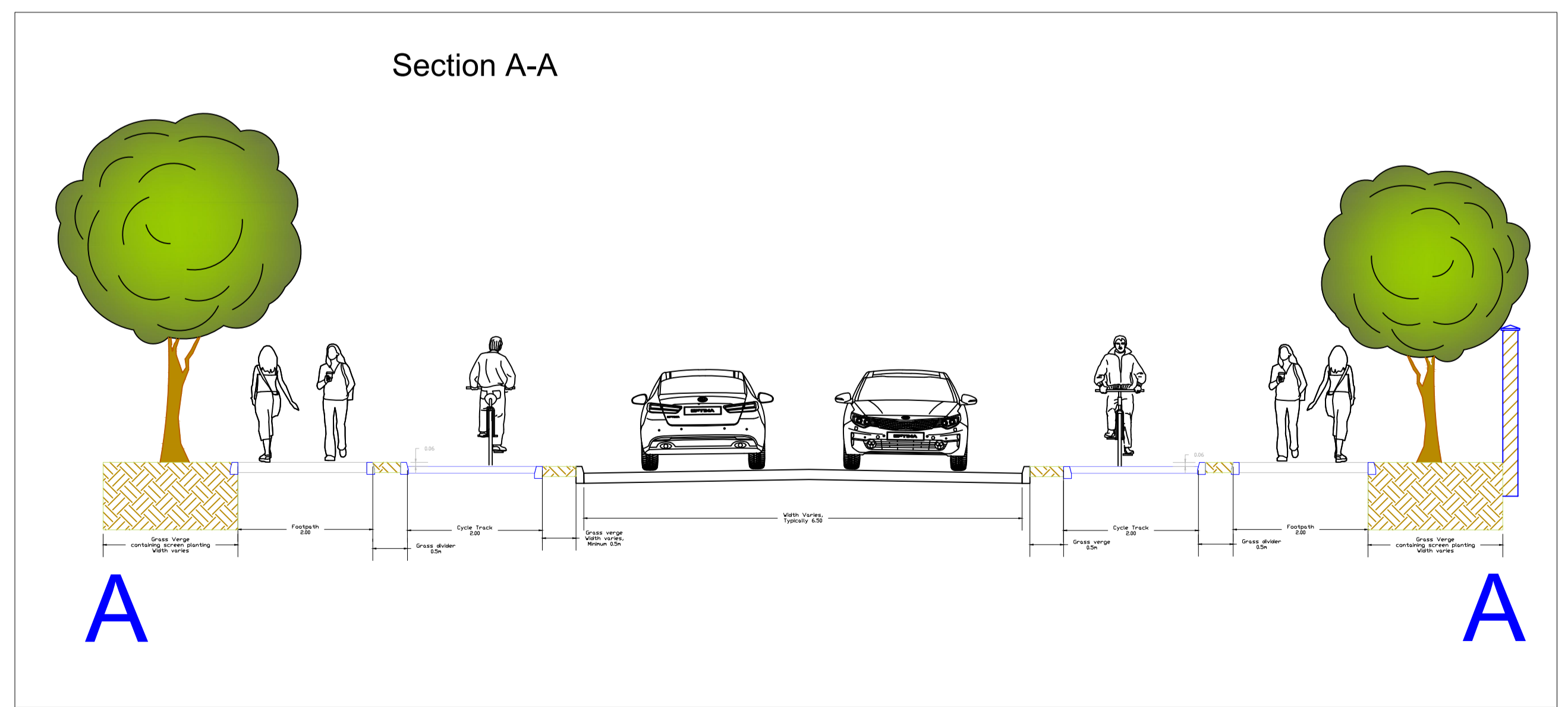

No.	Revision/Issue	Date

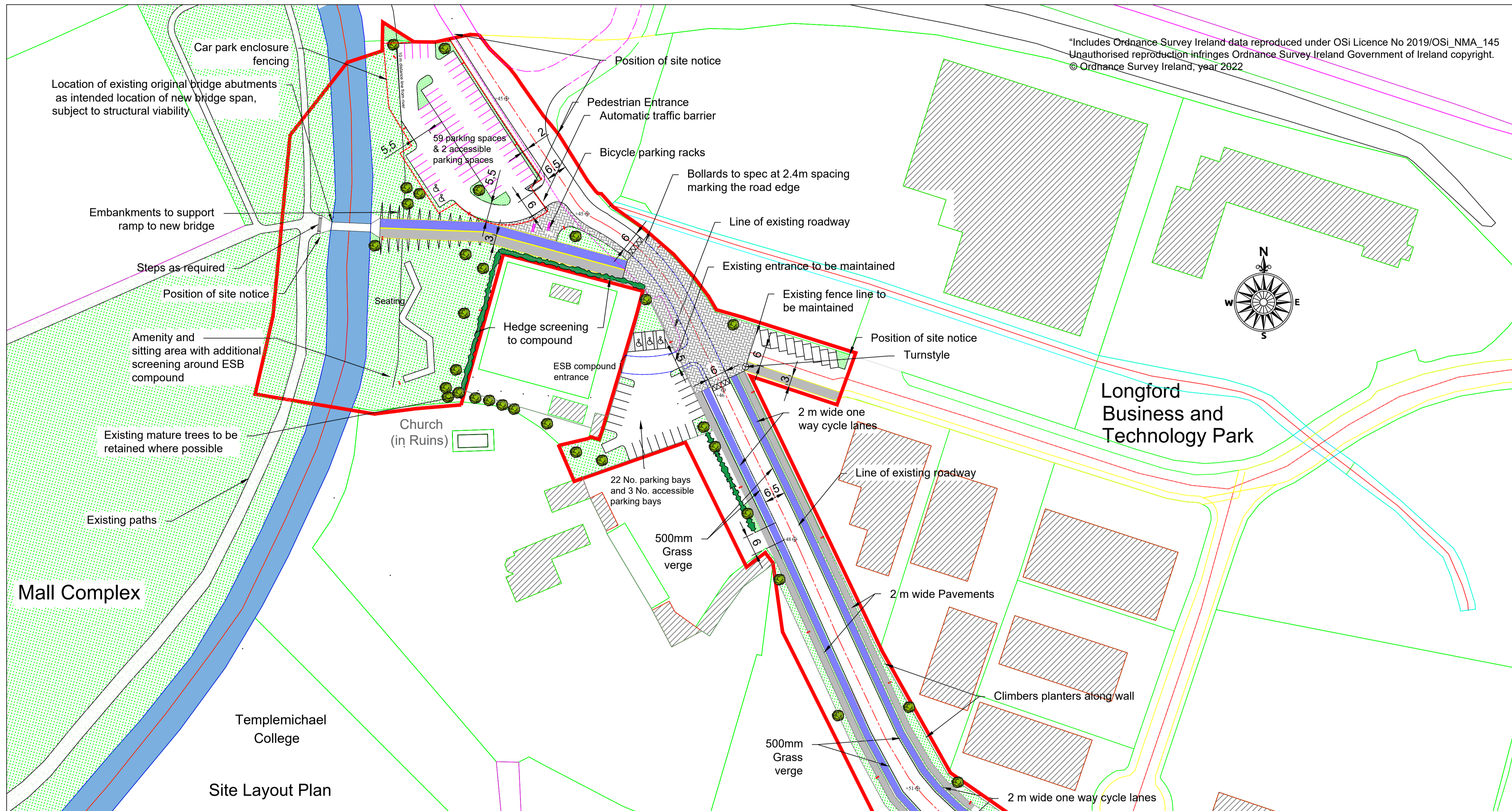

Project Name and Address
 Active Travel Project:
 Pedestrian & Cycle Scheme,
 Ballinalee Road to the Mall Complex,
 including new pedestrian bridge across
 the Camlin River.

Project Active Travel Project	Sheet 02
Date 26/08/2022	
Scale 1:750 & 1:50 @ A1	