

# LONGFORD COUNTY COUNCIL

## N55 Ballymahon - Improvement Works at Athlone Road Junction

### PUBLIC DISPLAY DRAWINGS (PART 8 PROCESS)

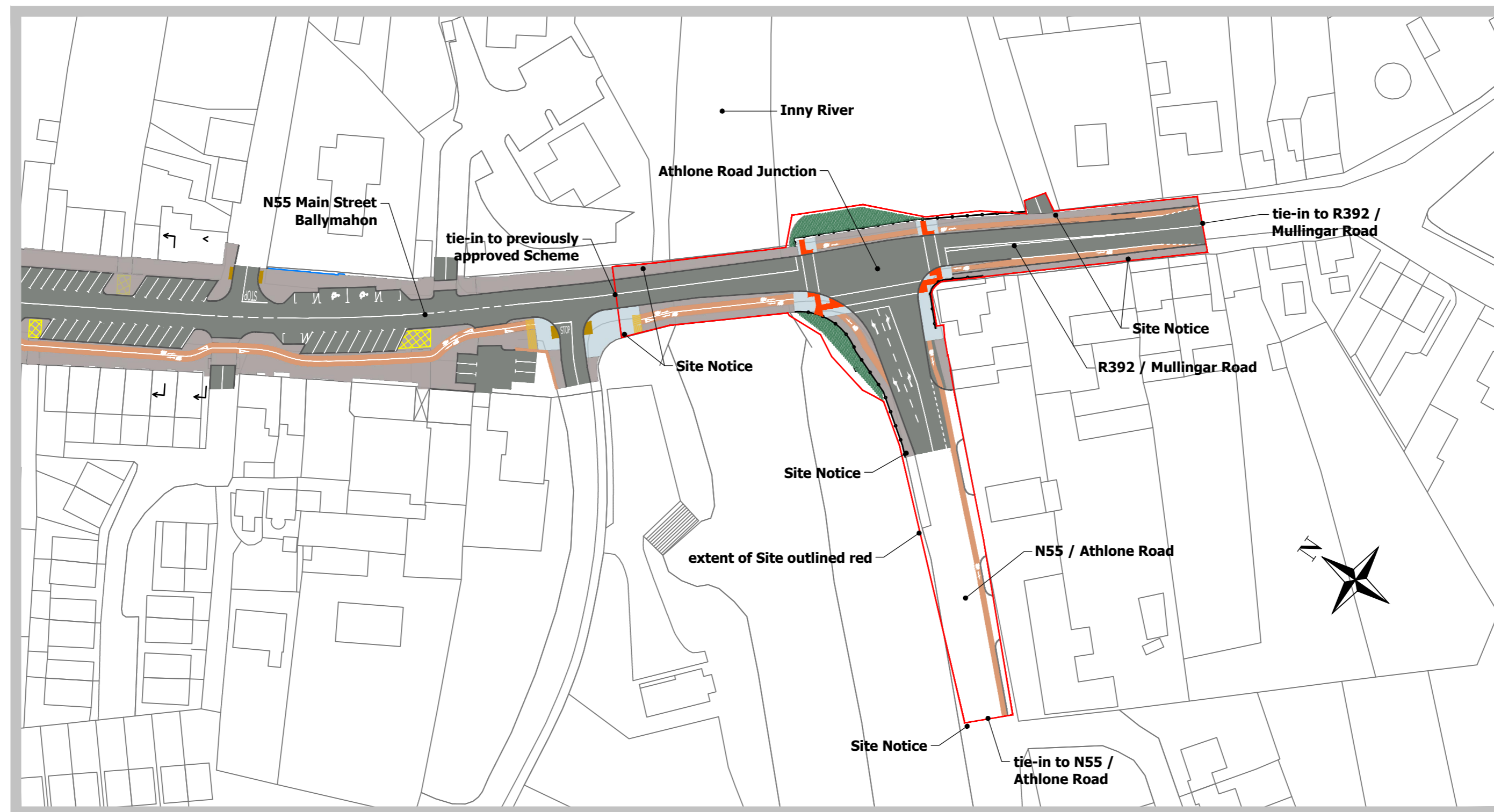

CLIENT  
LONGFORD COUNTY COUNCIL

STATUS  
FOR PART 8. NOT TO BE USED FOR ANY OTHER PURPOSE.

PROJECT  
N55 BALLYMAHON - IMPROVEMENT WORKS AT ATHLONE ROAD JUNCTION

TITLE  
COVER  
SITE LOCATION

OS mapping reproduced under licence.  
This drawing is the property of Kilgallen and Partners. Copyright.

**KILGALLEN & PARTNERS**  
CONSULTING ENGINEERS

WELL ROAD, KYLEKIPROE, PORTLAOISE      3 DANVILLE BUSINESS PARK, KILKENNY  
Tel: +353 57 86 62860, Fax: +353 57 86 62861      Tel: +353 56 770 1090, Fax: +353 56 770 5077  
E-mail: info@kilgallen.ie, Web: www.kilgallen.ie      E-mail: info@kilgallen.ie, Web: www.kilgallen.ie

REV	DATE	BY	DETAILS

DRN: SC	DRAWING NO.: 19007-DR-P8-01	REV.: PL1
CHKD: PB	SCALE: 1:1000 @ A2	DATE: 16/02/2023