

# PROPOSED SITE LAYOUT PLAN

SCALE 1:200 @ A1

INDICATES SITE BOUNDARY  
SITE AREA: 1.06 Ha / 2.61 Acre

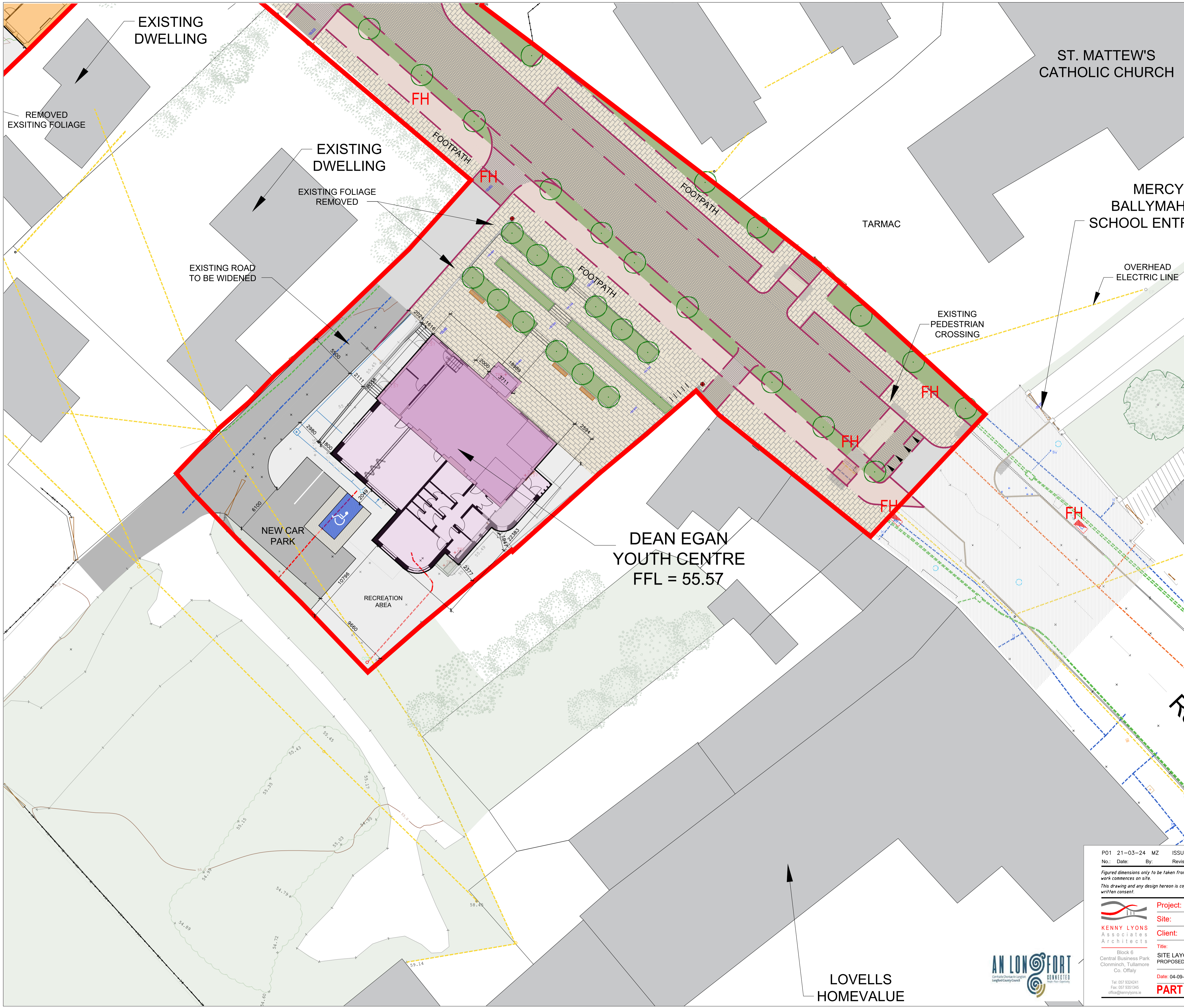
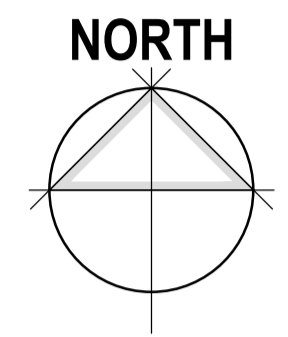

- PROPOSED DAY CARE & BRIDGEWAYS FAMILY RESOURCE CENTRE (RECONFIGURED)
- PROPOSED DAY CARE & BRIDGEWAYS FAMILY RESOURCE CENTRE (EXTENSION)
- PROPOSED COMMUNITY HALL
- PROPOSED SCHOOLHOUSE REMOTE WORKING HUB (RECONFIGURED)
- PROPOSED SCHOOLHOUSE REMOTE WORKING HUB (EXTENSION)
- PROPOSED DEAN EGAN YOUTH CENTRE (RECONFIGURED)
- PROPOSED DEAN EGAN YOUTH CENTRE (EXTENSION)
- EXISTING SURROUNDINGS BUILDINGS
- EXISTING SHED
- EXISTING ABOVE GROUND OIL TANKS
- EXISTING WAY LEAVE AREA
- EXISTING GRASS-LANDSCAPE
- EXISTING TARMAC-HARDSTANDING
- EXISTING HEDGE - FOLIAGE
- EXISTING FIRE HYDRANT LOCATIONS
- EXISTING TREES & HEDGROWS
- APPROX UNDERGROUND ES, ROUTE
- APPROX UNDERGROUND GAS ROUTE
- APPROX UNDERGROUND WATER MAIN

DEAN EGAN  
YOUTH CENTRE  
FFL = 55.57

EXISTING DWELLING

ST. MATTHEW'S  
CATHOLIC CHURCH

MERCY  
BALLYMAHON  
SCHOOL ENTR

TARMAC

EXISTING ROAD  
TO BE WIDENED

NEW CAR PARK

RECREATION AREA

EXISTING PEDESTRIAN  
CROSSING

OVERHEAD  
ELECTRIC LINE

LOVELLS  
HOMEVALUE

P01 21-03-24 MZ ISSUED FOR PLANNING

No.: Date: By: Revision:

Figured dimensions only to be taken from this drawing. All dimensions to be checked on site. Architects to be informed immediately of any discrepancies before work commences on site.  
This drawing and any design herein is copyright of Kenny Lyons + Associates Architects and must not be reproduced in whole or in part without their prior written consent.

**Project:** POBAIL LE CHEILE REGENERATION PROJECT

**Site:** MAIN STREET, BALLYMAHON, CO. LONGFORD

**Client:** LONGFORD COUNTY COUNCIL

**Title:** SITE LAYOUT PLAN  
PROPOSED DEAN EGAN YOUTH CENTRE

**Block 6**  
Central Business Park  
Clonminch, Tullamore  
Co. Offaly

**Draw. No.:** 2045-KLA-00-00-DR-A-010

**Rev:** P01

**Date:** 04-09-23 **Scale:** 1:200 **Drawn by:** MZ **Checked:** NM:d

**PART VIII SUBMISSION**

Tel: 057 9324241  
Fax: 057 9351345  
office@kennylyons.ie

**AN LONGFORD**  
BORROWERS

© 2024



# PROPOSED SITE LAYOUT PLAN

SCALE 1:200 @ A1

INDICATES SITE BOUNDARY  
SITE AREA: 1.06 Ha / 2.61 Acre

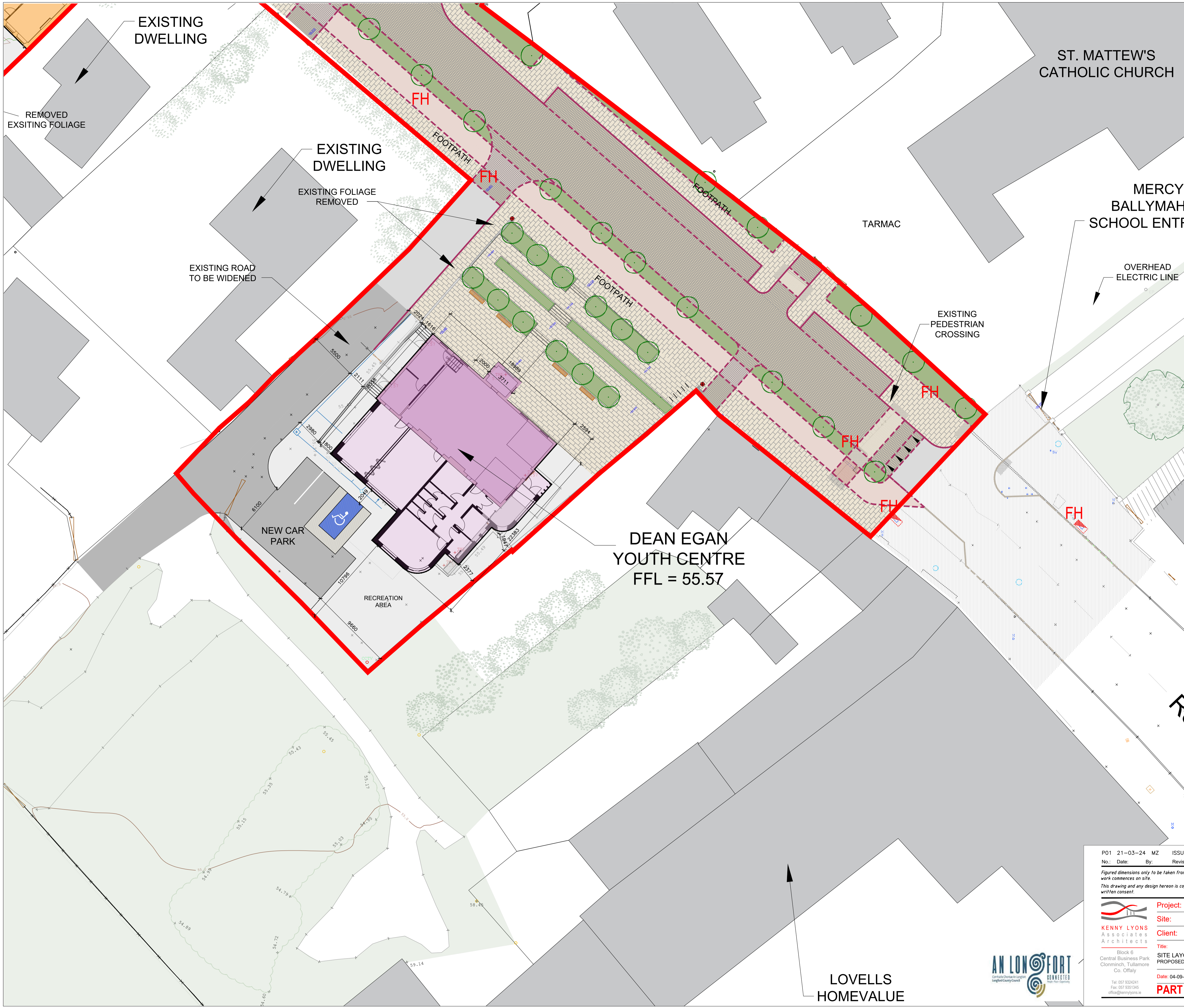
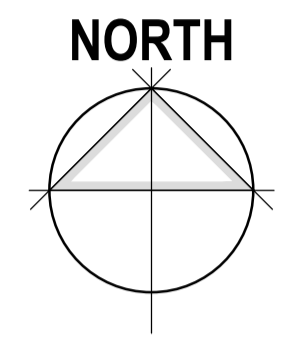

- FORMER CONVENT EXISTING BUILDING
- FORMER CONVENT PROPOSED EXTENSION
- PROPOSED COMMUNITY HALL
- SCHOOLHOUSE EXISTING BUILDING
- SCHOOLHOUSE PROPOSED EXTENSION
- DEAN EGAN EXISTING BUILDING
- DEAN EGAN PROPOSED EXTENSION
- EXISTING SURROUNDINGS BUILDINGS
- EXISTING SHED
- EXISTING ABOVE GROUND OIL TANKS
- EXISTING WAY LEAVE AREA
- EXISTING GRASS-LANDSCAPE
- EXISTING TARMAC-HARDSTANDING
- EXISTING HEDGE - FOLIAGE
- FH EXISTING FIRE HYDRANT LOCATIONS
- EXISTING TREES & HEDGROWS

P01 21-03-24 MZ ISSUED FOR PLANNING  
 No.: Date: By: Revision:

Figured dimensions only to be taken from this drawing. All dimensions to be checked on site. Architects to be informed immediately of any discrepancies before work commences on site.  
 This drawing and any design herein is copyright of Kenny Lyons + Associates Architects and must not be reproduced in whole or in part without their prior written consent.

**Project:** POBAIL LE CHEILE REGENERATION PROJECT  
**Site:** MAIN STREET, BALLYMAHON, CO. LONGFORD  
**Client:** LONGFORD COUNTY COUNCIL

**Kenny Lyons Associates Architects**  
 Block 6  
 Central Business Park  
 Clonminch, Tullamore  
 Co. Offaly  
 Tel: 057 9324241  
 Fax: 057 9351345  
 office@kennylyons.ie

**AN LONGFORD COUNCIL**  
 Central Business Park  
 Clonminch, Tullamore  
 Co. Offaly  
 Tel: 057 9324241  
 Fax: 057 9351345  
 office@anlongford.ie

**Rev:** 2045-KLA-00-00-DR-A-010 P01  
**Date:** 04-09-23 **Scale:** 1:200 **Drawn by:** MZ **Checked:** NM:d  
**PART VIII SUBMISSION**

LOVELLS HOMEVALUE