

12 December 2022

Re: Proposed Residential Zoned Vacant/Derelict Land Tax

Dear Sir,

I refer to above and wish to state that it has just come to my attention that it is proposed to alter zoning of my garden to the rear of my dwelling at  Clondra from agricultural to residential. I understand that this proposal is for the purpose of activating vacant/derelict land for residential purposes.

I wish to confirm that this garden has been in continual use for animal grazing and hay harvesting over my lifetime. For the past twelve years it has been a sanctuary to my two rescue donkeys. It has therefore never been vacant or allowed into dereliction. On the contrary it has been upgraded significantly to meet the standards of the ISPCA and for the safety and security of the animals. A stable and pen has been provided. Wooden gates and extensive wooden fencing with electrical conduit have been erected. New hedging has been planted along the western boundary. Adjacent laneway has been upgraded for vehicular access. All this has been done at considerable cost.

Should the zoning status of this piece of ground be altered to residential and incur residential land tax I would be forced to house or pin the donkeys on a permanent basis. That of course would be impossible as the donkeys require this garden for grazing and sustenance. It is of a desirable size to allow them to browse and lead a comfortable life.

Also, while I enjoy their presence and care they provide interest and enjoyment to visitors to the village.

I therefore wish to submit this application against the alteration of zoning of this garden from agricultural to residential on the above detailed grounds.

In support of this submission, I enclose copies of both Ordnance Survey place map and of proposed re zoning map. The ground in question is marked in pencil with an X for identification purposes on both these maps.

In respect of proof of my ownership of the said garden I enclose three Folio Numbers pertaining to same.

Yours sincerely,



Encls...4

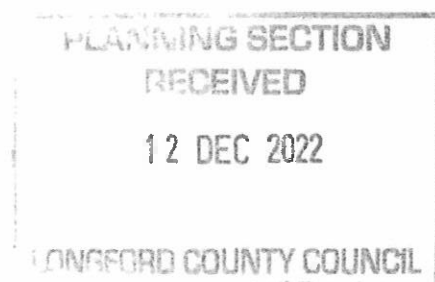
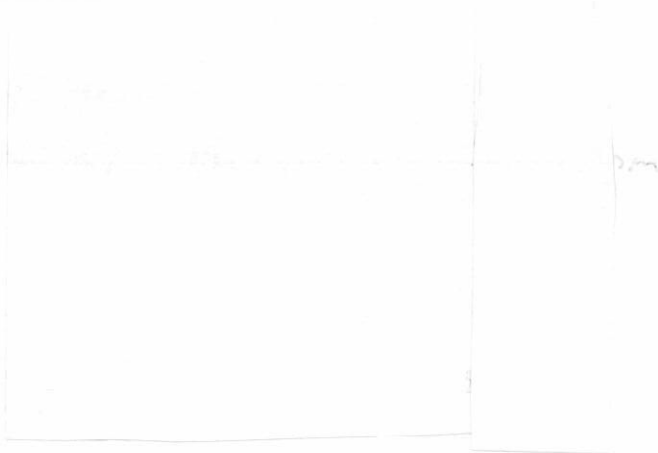

Royal PLACE Map

Surveyed 1911 - 2001
 Revised 0
 Levelled 0

206170
 275351



DESCRIPTION

**PLANNING SECTION
 RECEIVED**

12 DEC 2022

MAP SCALES
 1:2500
 1:2500-B
 5 inch
 D013-05

LONGFORD COUNTY COUNCIL



Printed by The Map Studio
 Church Avenue Mullingar
 On behalf of Ordnance Survey Ireland
 Situaicán allagaird / ionadair / ionadair
 Stairbhreaght, Oribairíle Éireann agus
 na hÉireann
 The map is produced in association with the Ordnance Survey Ireland and Government of Ireland
 copyright.

Each copy of this map, or any part thereof, is sold on the basis that the purchaser undertakes to use it for the purposes for which it is intended. The Ordnance Survey does not warrant the accuracy of the information contained in the map. All rights reserved. No part of this publication may be copied, reproduced or transmitted in any form or by any means without the prior written permission of the copyright owners.

© Survbairéacht Éireann, 2002
 © Ordnance Survey Ireland, 2002

206745
 275776

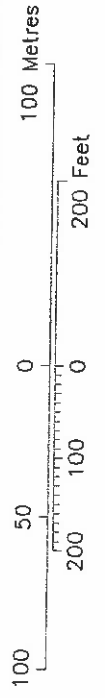
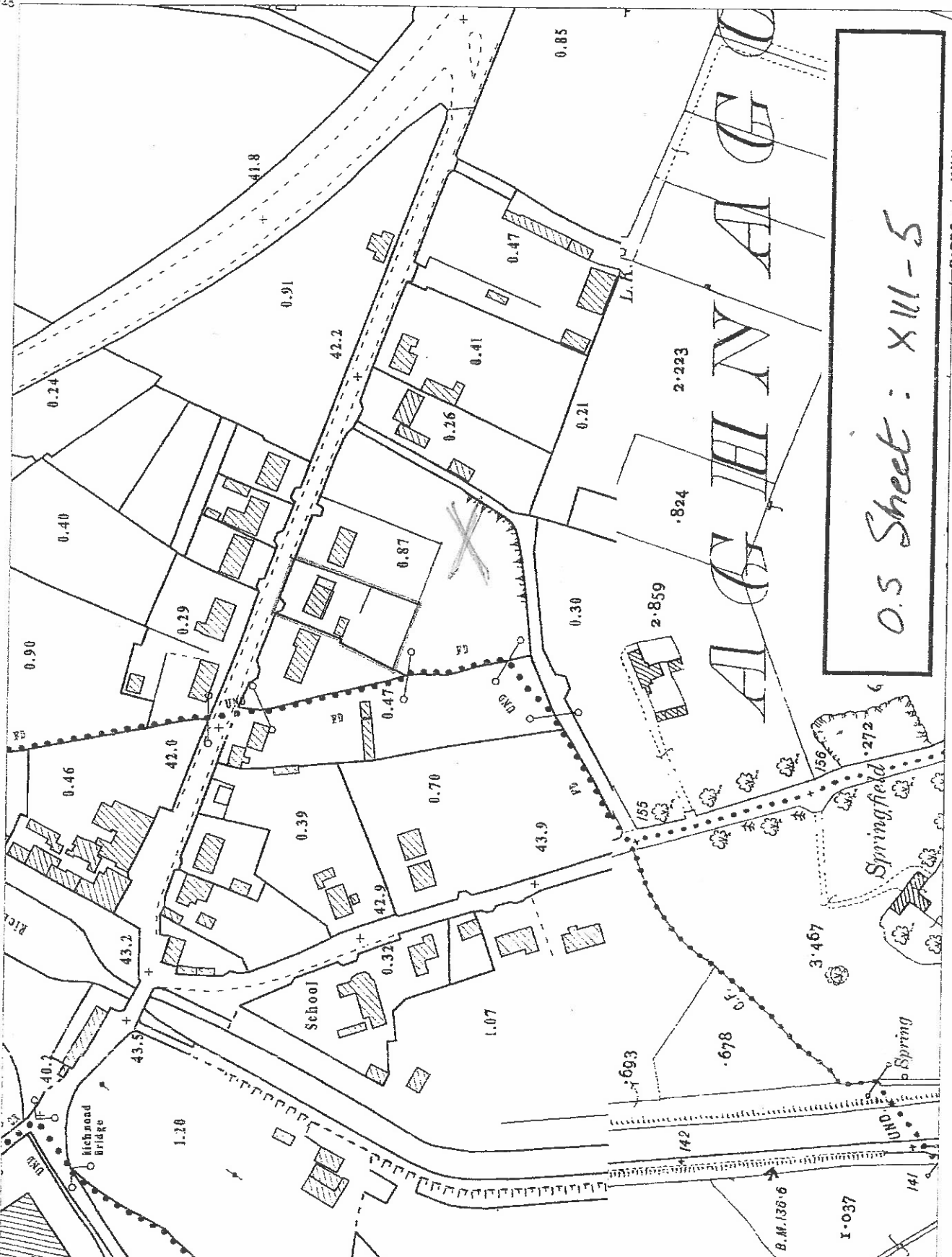

Scale: — 1:2500
 Scala: — 1:2500

Plot Ref. No. 9141_1_3
 Plot Date 25-AUG-2003

275351
 206745

275351
 206170