

---

**From:**  
**Sent:** Tuesday 3 January 2023 20:34  
**To:** RZLT  
**Subject:** EXTERNAL - Residential Zoned Land Tax  
**Attachments:**

**CAUTION: This email originated from outside of the organization. Do not click links or open attachments unless you recognize the sender and know the content is safe.**

Hi,

I refer to the above, we as owners of land which is part of [redacted] located at Drumlish, Co. Longford wish to challenge the inclusion of PARCEL ID LDLA202202679, PARCEL ID LDLA202201807, AND PARCEL ID LDLA202201808 on the draft map.

We attach copy of [redacted] showing [redacted] as registered owners along with both Ordnance Survey map (scale 1:2500) and relevant extract from draft map referred to above.

We request that the above referenced lands are removed from the relevant map for the following reasons:

The land in question does not meet the criteria set out in Section 653B subsection (b) of the Taxes Consolidation Act 1997 (as amended by subsequent Acts up to, and including, the Finance Act 2022) as it does not have access, or be connected, to public infrastructure.

Furthermore, in the current economic climate it would be uneconomical to develop the lands in question given the increase in costs of construction combined with a cost of living crisis which creates a lot of uncertainty in the residential housing market especially in the rural village Drumlish.

It would currently be uneconomical to develop/construct public infrastructure and facilities including roads and footpaths, public lighting, foul sewer drainage, surface water drainage and water supply as referenced in Section 653B subsection (b) of the Taxes Consolidation Act 1997 (as amended by subsequent Acts up to, and including, the Finance Act 2022)

Accordingly, we request PARCEL ID LDLA202202679, PARCEL ID LDLA202201807, AND PARCEL ID LDLA202201808 all be removed from the draft map.

Surveyed 1911  
 Revised 0  
 Levelled 0

# Rural PLACE Map



DESCRIPTION



MAP SCALES

25inch LD005-09 LD005-09



Subsidiary Ordnance Survey  
 information, under Act 1947, is  
 a copyright work of the Ordnance  
 Survey. It is published and published  
 under the Ordnance Survey Act, 1947.  
 No person shall, without the written  
 consent of the Ordnance Survey,  
 reproduce or cause to be reproduced  
 in any form or by any means  
 electronic, mechanical, photocopying,  
 recording, or by any information  
 storage and retrieval system, any  
 part of this work, or to transmit or  
 cause to be transmitted in any form  
 or by any means electronic, mechanical,  
 photocopying, recording, or by any  
 information storage and retrieval system,  
 any part of this work, or to make  
 available in any form or by any means  
 electronic, mechanical, photocopying,  
 recording, or by any information  
 storage and retrieval system, any part  
 of this work, or to cause or to attempt  
 to cause any person to do so.

© Ordnance Survey, 2000  
 © Government of Ireland, 2000

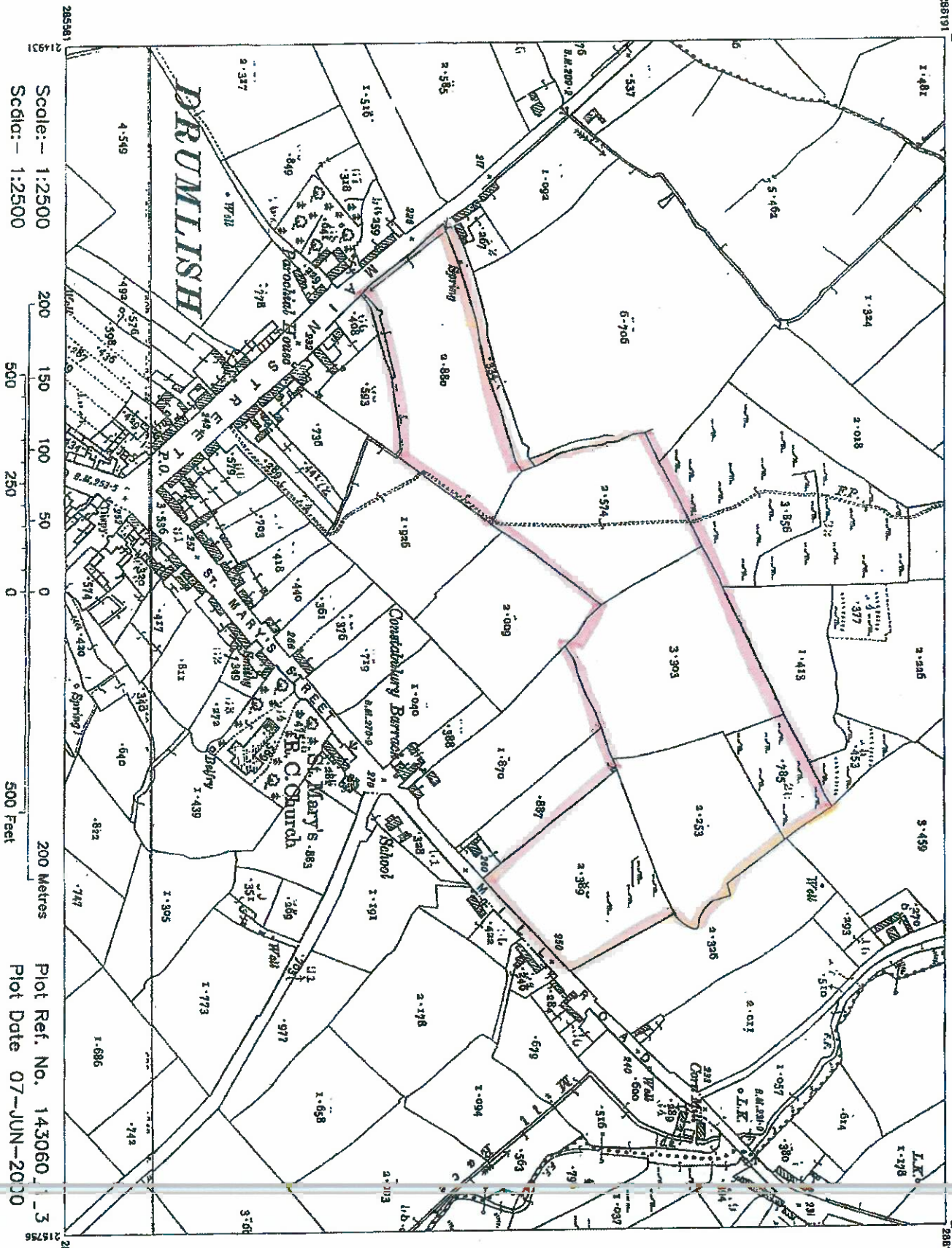

Scale: 1:2500  
 Scale: 1:25000



Plot Ref. No. 143060\_3  
 Plot Date 07-JUN-2000